

\\ctarfil02\Eng\Projects\2024\24-0055-EC.dwg [C-1] May 27, 2025 9:21am TRUBINO

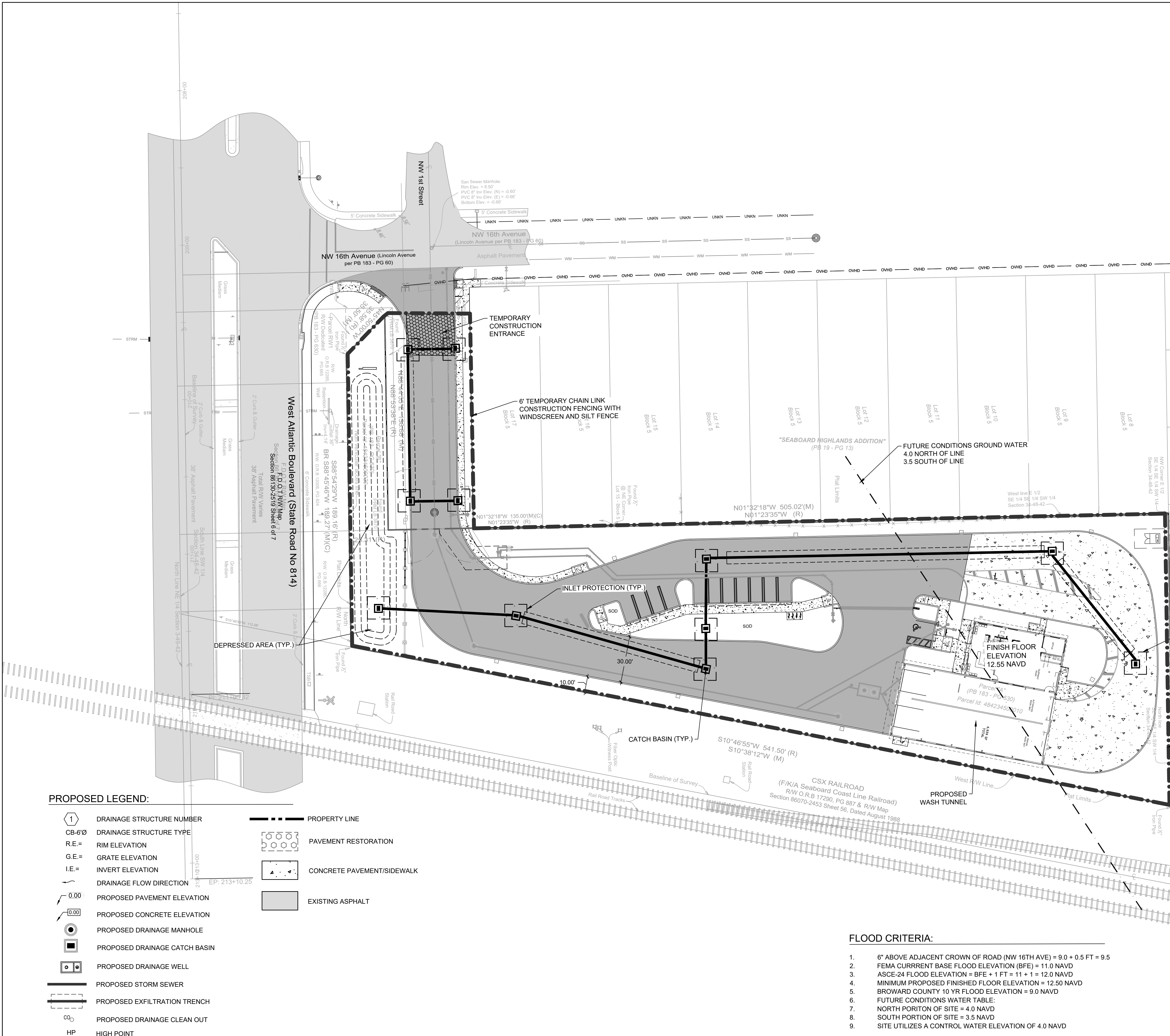

PROPOSED LEGEND:

- | | | | |
|--|----------------------------------|--|----------------------------|
| | 1 DRAINAGE STRUCTURE NUMBER | | PROPERTY LINE |
| | CB-6'Ø DRAINAGE STRUCTURE TYPE | | PAVEMENT RESTORATION |
| | R.E.= RIM ELEVATION | | CONCRETE PAVEMENT/SIDEWALK |
| | G.E.= GRATE ELEVATION | | EXISTING ASPHALT |
| | I.E.= INVERT ELEVATION | | |
| | DRAINAGE FLOW DIRECTION | | |
| | 0.00 PROPOSED PAVEMENT ELEVATION | | |
| | 0.00 PROPOSED CONCRETE ELEVATION | | |
| | PROPOSED DRAINAGE MANHOLE | | |
| | PROPOSED DRAINAGE CATCH BASIN | | |
| | PROPOSED DRAINAGE WELL | | |
| | PROPOSED STORM SEWER | | |
| | PROPOSED EXFILTRATION TRENCH | | |
| | PROPOSED DRAINAGE CLEAN OUT | | |
| | HP HIGH POINT | | |

FLOOD CRITERIA:

- 6" ABOVE ADJACENT CROWN OF ROAD (NW 16TH AVE) = 9.0 + 0.5 FT = 9.5
- FEMA CURRENT BASE FLOOD ELEVATION (BFE) = 11.0 NAVD
- ASCE-24 FLOOD ELEVATION = BFE + 1 FT = 11 + 1 = 12.0 NAVD
- MINIMUM PROPOSED FINISHED FLOOR ELEVATION = 12.50 NAVD
- BROWARD COUNTY 10 YR FLOOD ELEVATION = 9.0 NAVD
- FUTURE CONDITIONS WATER TABLE:
- NORTH PORTION OF SITE = 4.0 NAVD
- SOUTH PORTION OF SITE = 3.5 NAVD
- SITE UTILIZES A CONTROL WATER ELEVATION OF 4.0 NAVD

VERTICAL INFORMATION HEREON IS RELATIVE TO THE NORTH AMERICAN VERTICAL DATUM (NAVD88). [NAVD88 = NGVD29 - 1.59']

This document has been digitally signed and sealed by Chad Everett Edwards, P.E. on the date indicated here. Printed copies of this document are not considered signed and sealed and the signature must be verified on any electronic copies.

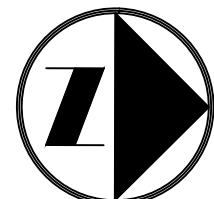

SCALE: 1" = 30'

NOTES:

- CONTRACTOR SHALL ASSUME ANY AND ALL RESPONSIBILITIES FOR ANY WATER CONTROL VIOLATIONS RESULTING FROM FAILURE TO ELIMINATE AND/OR CONTROL TURBID RUNOFF FROM LEAVING THE SITE AS ISSUED BY ANY AGENCY HAVING JURISDICTION.
- CONTRACTOR SHALL PROVIDE TEMPORARY DEWATERING AREA(S) PRIOR TO ANY EXCAVATION FOR PIPE INSTALLATION. DEWATERING AREA(S) SHALL BE PROTECTED WITH SILT SCREENS. ALL DEWATERING OPERATIONS SHALL DISCHARGE INTO TEMPORARY DEWATERING AREA(S) AND NO DIRECT DISCHARGE INTO THE EXISTING OR NEW DITCHES, STORM DRAINS, AND/OR PUBLIC RIGHT OF WAY WILL BE ALLOWED.
- CONTRACTOR SHALL MAINTAIN A POLLUTION PREVENTION CONTROL LOG AND CONDUCT WEEKLY INSPECTIONS AND WITHIN 24 HOURS OF A 0.25" STORM EVENT.
- CONTRACTOR TO EMPLOY BEST MANAGEMENT PRACTICES THROUGHOUT CONSTRUCTION IN ORDER TO ENSURE POLLUTION PREVENTION. CONTRACTOR TO COMPLY WITH ALL LOCAL, STATE, AND OTHER LOCAL GOVERNMENTAL ENVIRONMENTAL REGULATIONS THROUGHOUT CONSTRUCTION.
- DURING CONSTRUCTION, ALL CATCH BASINS TO BE EQUIPPED WITH FILTER FABRIC AND HAY BALES OVER GRATES.
- ALL AREAS DISTURBED DURING CONSTRUCTION SHALL BE STABILIZED WITHIN A REASONABLE PERIOD OF TIME TO ASSURE MINIMUM EROSION OF SOILS.
- NO LAND CLEARING OR GRADING SHALL BEGIN UNTIL ALL EROSION CONTROL MEASURES HAVE BEEN INSTALLED.
- ADDITIONAL EROSION AND SEDIMENT CONTROL MEASURES SHALL BE INSTALLED IF DEEMED NECESSARY. ADDITIONAL CONTROL MEASURES SHALL BE INSTALLED AT CONTRACTORS EXPENSE.

DRC

PZ24-12000026

07.02.2025

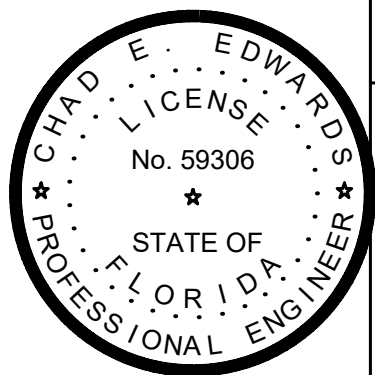

1501 WEST ATLANTIC BLVD.
POMPAO BEACH, FLORIDA

PREPARED FOR:
KAJA PROPERTIES INC.

EROSION CONTROL PLAN

CRAVEN • THOMPSON AND ASSOCIATES, INC.
ENGINEERS • PLANNERS • SURVEYORS
35653 N.W. 53RD STREET, FORT LAUDERDALE, FLORIDA 33309
FAX: (954) 739-6409 TEL: (954) 739-6400

FLORIDA LICENSED ENGINEERS, SURVEYORS & PLANNERS BUSINESS NO. 271
FLORIDA LICENSED LANDSCAPE ARCHITECTURE BUSINESS NO. C00014

MATERIAL SHOWN HEREON IS THE PROPERTY OF CRAVEN, THOMPSON & ASSOCIATES, INC. AND SHALL NOT BE REPRODUCED OR TRANSMITTED IN ANY FORM OR BY ANY MEANS, ELECTRONIC OR MECHANICAL, INCLUDING PHOTOCOPYING, RECORDING, OR BY ANY INFORMATION STORAGE AND RETRIEVAL SYSTEM, WITHOUT THE WRITTEN PERMISSION OF CRAVEN, THOMPSON & ASSOCIATES, INC. COPYRIGHT © 2025

CHAD E. EDWARDS, P.E.
FLORIDA LICENSE NO. 59306
2025-05-27

PROJECT NO.
24-0055-001-01

C-1
SHEET 1 OF 14

DATE:	04/30/25
SCALE:	AS SHOWN
DESIGN BY:	CEE
DRAWN BY:	TR
CHECKED BY:	CEE
APPROVED BY:	CEE
BY:	DATE:
DESCRIPTION:	